



TECHNICAL FILE:

Double - 3 way switch
(Momentaneous- OFF – Momentaneous)

1.- Technical specifications

Rated voltage: 250 V ~

Rated current: 6 A

3 way switch (momentaneous-OFF-momentaneous)

Manufactured according EN 61-058-1 standard

Clamping with screw terminals

Electrical life:10.000 cycles at full load

Flush mounting in universal box according EN-60-670 standard

Any plate combination can be produced combining switches, sockets, dimmers,...

Any plate size according to your requirements.

2.- Material characteristics

Body: Polyster UL94 V-0

Terminals: Silver/nickel alloy

Toggle: Zamak

Ring: Brass (optional)

Plate: AISI 304 Stainless steel, aluminium, brass and Corian®.

Frame: Zamak (optional)

Height dimensions (size in mm)

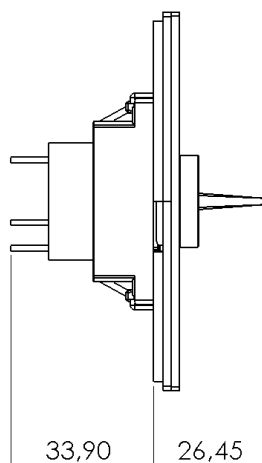
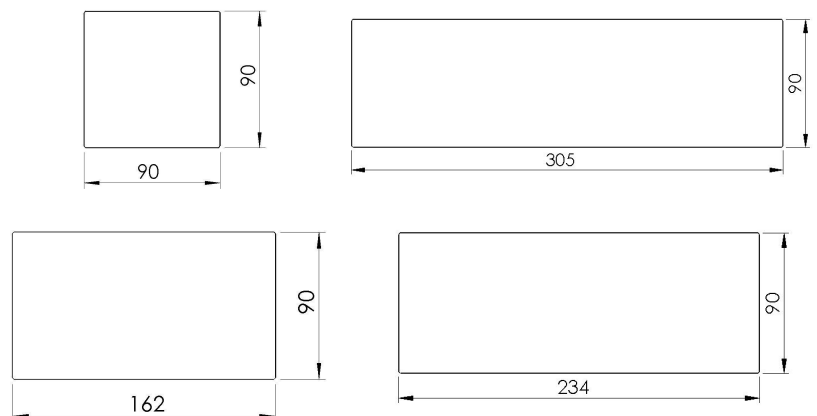

Plate dimensions (size in mm)



Technical details

